

ARMING THE IMMOBILISER

The immobiliser will passive set after turning the ignition off. It will either set after 5 minutes or 55 seconds after opening a door.

DISARMING THE IMMOBILISER

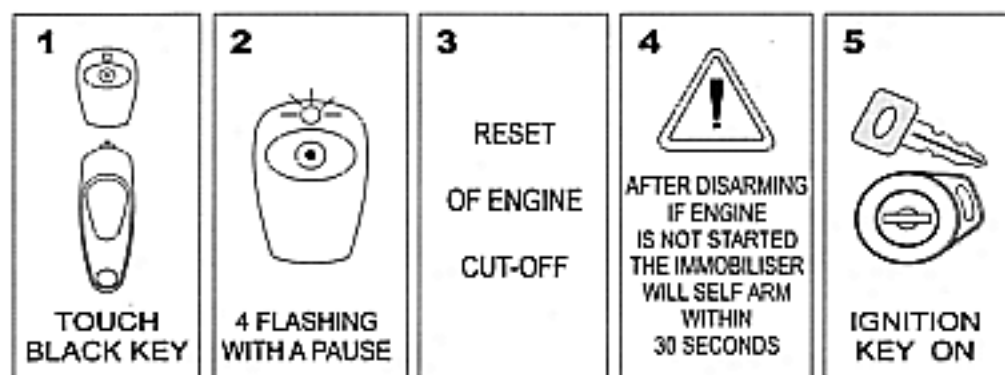

SCHEDULE OF LED SIGNALS

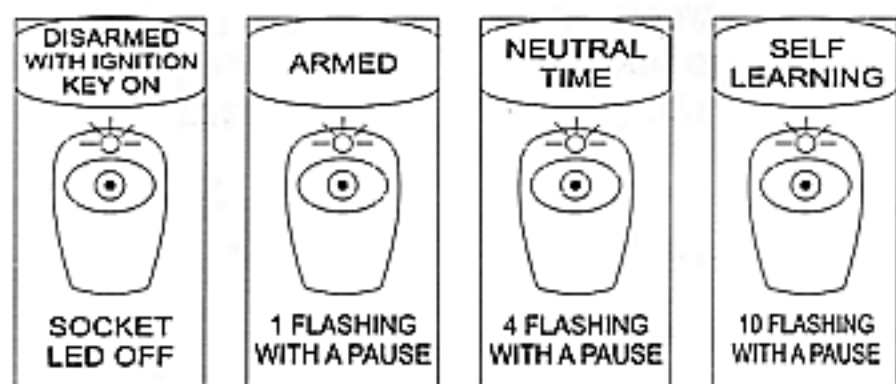

The technical information contained in this publication, to our knowledge were correct at the time of going to print.

The right to change specification and equipment at any time, without notice, is reserved as part of our policy of continuous development and improvement.

No part of this publication may be reproduced, stored in a retrieval system or transmitted in any form, electronic, mechanical, photocopying, recording, translating or other means without written permission of Selca S.P.A.

No liability can be accepted for any inaccuracies or omissions in this publication although every possible care has been taken to make it as complete and accurate as possible. Selca S.P.A. cannot accept liability to any alterations, modifications or additions to the immobiliser system or installation. As such alterations or modifications may invalidate the certificate of compliance or installation.

In the event of a failure or key loss contact your Authorised Installer.

CODING NEW TOUCH KEYS

1- DISARM THE IMMOBILISER

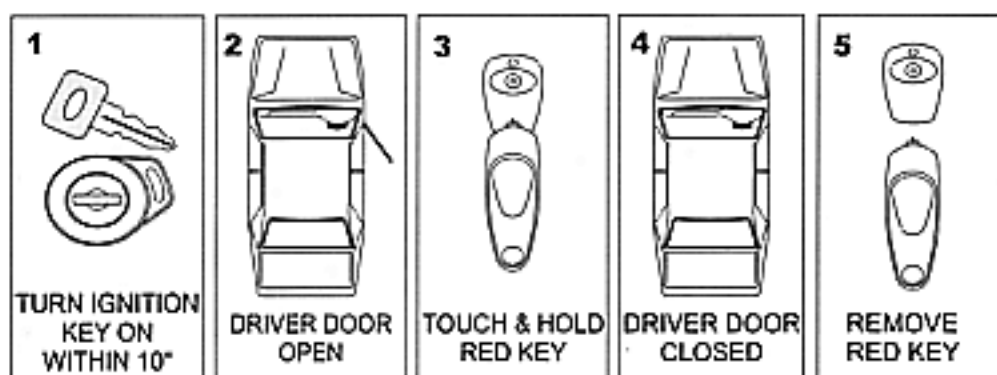

The confirmation is given by 10 flash followed by a series of 1 flash 1 pause.

All the original black keys are erased.

The system is ready to learn the key codes up to 5 black keys.

2- BLACK KEYS AUTO LEARNING

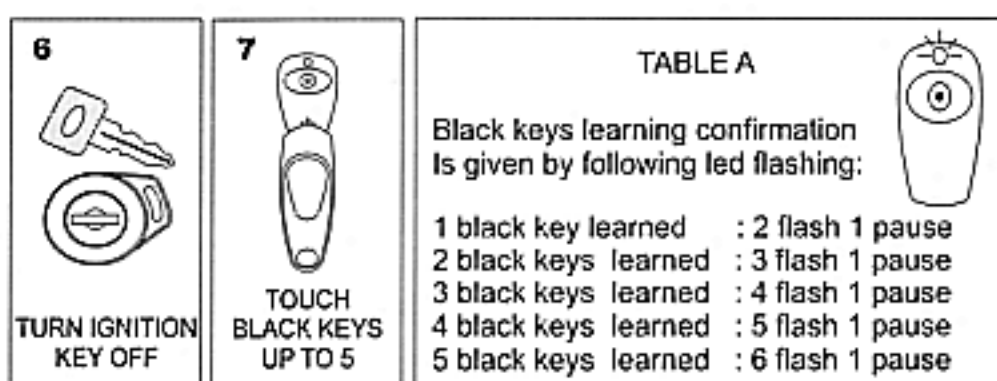

3- EXIT AUTOLEARNING MODE

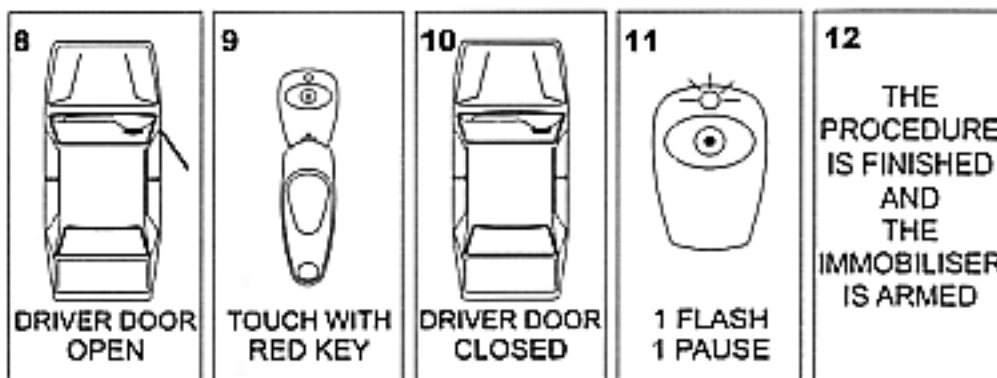

CHECK THE NUMBER OF CODED TOUCH KEYS.

- 1 Disarm the immobiliser.
- 2 Switch the ignition on.
- 3 Touch the coded touch key onto the disarm socket.
- 4 Watch the L.E.D. in the disarm socket (Table "A")